

HFO

HÜCRELİ FANLAR VENTILATION UNITS



- 1000 m³/h – 38.000 m³/h hava debisi aralığında çalışmaktadır
- Balansı alınmış alçak basınçlı sık kanatlı salyangoz fanlar ve yüksek basınçlı seyrek kanatlı salyangoz fanlar kullanılmaktadır.
- Kabinler isteğe bağlı tek veya çift cidarlı yapılabilmektedir.
- Cidarlar arasında 40 kg/m³ yoğunluğuna sahip polietilen köpük izolasyon malzemesi kullanılmaktadır.
- Müdahale kapağı açılmadan kabinin içerisini izlemeyi sağlayan gözetleme camı mevcuttur. İsteğe bağlı olarak iki tarafında da gözetleme camı olacak şekilde imal edilebilir.
- Kayışların gerginleşmesini sağlayan kayış gerdirme aparatı mevcuttur.
- Motor 230 V tek fazlı ve 380 V Üç fazlı olabilmektedir. IP 55 – Class F sınıfı motora sahiptir.

- Has air flow between 1.000 m³/h and 38.000 m³/h.
- Balanced low pressure forward curved centrifugal fans or high pressure backward curved centrifugal fans can be used.
- Cabins can be optionally single or double wall.
- Between the internal walls, 40 kg / m³ density polyethylene foam insulation material is used. As an option, can be produced with two sight glass on both sides.
- Has a sight glass which is available to watch the inside of the cabin without opening the door. As an option, can be produced with two sight glass on both sides.
- Belt tensioning device allows the belts are severed.
- Single phase or three phase motors are available.

Application Areas: Can be use in the hospitals, offices, malls, supermarkets, universities and other industrial places.

22

Kullanım alanları : Hastaneler, Ofisler, Alışveriş Merkezleri, Süpermarketler, Üniversiteler vb. mekânlarda kullanılmaktadır.



TEKNİK TABLO / TECHNICAL PARAMETERS

| Tip Type | Voltaj Voltage | Frekans Frequency | Güç Power | Devir Speed | Debi Air Flow | Basınç Pressure | Ses Seviyesi Sound Pressure Level | Ağırlık Weight |
|------------------------------|-------------------|----------------------|--------------|----------------|------------------|--------------------|--------------------------------------|-------------------|
| | V | Hz | Kw | d/d | m³/h | Pa | dB(A) | Kg |
| HFO-7A-4K-M HFO-7A-4K-T | 220 380 | 50 | 0,25 | 1360 | 1000 | 250 | 49 | 65 |
| HFO-7B-4K-M HFO-7B-4K-T | 220 380 | 50 | 0,37 | 1485 | 1250 | 300 | 51 | 66 |
| HFO-7C-4K-M HFO-7C-4K-T | 220 380 | 50 | 0,55 | 1700 | 1400 | 350 | 54 | 68 |
| HFO-7D-4K-M HFO-7D-4K-T | 220 380 | 50 | 0,75 | 1975 | 1500 | 400 | 57 | 69 |
| HFO-9A-4K-M HFO-9A-4K-T | 220 380 | 50 | 0,37 | 1110 | 1800 | 200 | 52 | 75 |
| HFO-9B-4K-M HFO-9B-4K-T | 220 380 | 50 | 0,55 | 1115 | 2200 | 250 | 52 | 76 |
| HFO-9C-4K-M HFO-9C-4K-T | 220 380 | 50 | 0,75 | 1210 | 3000 | 300 | 53 | 77 |
| HFO-9D-4K-M HFO-9D-4K-T | 220 380 | 50 | 1,1 | 1395 | 3750 | 400 | 58 | 80 |
| HFO-10A-4K-M HFO-10A-4K-T | 220 380 | 50 | 0,55 | 820 | 3800 | 150 | 52 | 83 |
| HFO-10B-4K-M HFO-10B-4K-T | 220 380 | 50 | 0,75 | 925 | 4100 | 200 | 55 | 84 |
| HFO-10C-4K-M HFO-10C-4K-T | 220 380 | 50 | 1,1 | 1035 | 4800 | 250 | 58 | 87 |
| HFO-10D-4K-M HFO-10D-4K-T | 220 380 | 50 | 1,5 | 1240 | 5400 | 400 | 60 | 89 |
| HFO-12A-4K-M HFO-12A-4K-T | 220 380 | 50 | 0,75 | 690 | 5200 | 200 | 53 | 111 |
| HFO-12B-4K-M HFO-12B-4K-T | 220 380 | 50 | 1,1 | 845 | 5800 | 250 | 56 | 114 |
| HFO-12C-4K-M HFO-12C-4K-T | 220 380 | 50 | 1,5 | 925 | 6500 | 300 | 58 | 115 |
| HFO-12D-4K-M HFO-12D-4K-T | 220 380 | 50 | 2,2 | 1000 | 7400 | 350 | 61 | 120 |
| HFO-15A-4K-M HFO-15A-4K-T | 220 380 | 50 | 1,5 | 660 | 8000 | 200 | 57 | 131 |
| HFO-15B-4K-M HFO-15B-4K-T | 220 380 | 50 | 2,2 | 700 | 500 | 250 | 60 | 135 |
| HFO-15C-4K-M HFO-15C-4K-T | 220 380 | 50 | 3 | 850 | 10000 | 300 | 62 | 139 |
| HFO-15D-4K-T | 380 | 50 | 4 | 860 | 12000 | 350 | 65 | 145 |
| HFO-18A-4K-M HFO-18A-4K-T | 220 380 | 50 | 3 | 510 | 12000 | 200 | 59 | 177 |
| HFO-18B-4K-T | 380 | 50 | 4 | 580 | 14000 | 250 | 62 | 180 |
| HFO-18C-4K-T | 380 | 50 | 5,5 | 615 | 16000 | 250 | 65 | 188 |
| HFO-18D-4K-T | 380 | 50 | 7,5 | 720 | 18000 | 300 | 68 | 192 |
| HFO-20-4K-T | 380 | 50 | 11 | 725 | 22000 | 400 | 65 | 285 |
| HFO-22-4K-T | 380 | 50 | 15 | 765 | 27000 | 400 | 67 | 335 |
| HFO-25-4K-T | 380 | 50 | 18,5 | 610 | 38000 | 400 | 68 | 380 |

*Ses seviyesi 3m mesafeden ölçülmüştür. / Sound levels has measured at a distance of 3 meters.

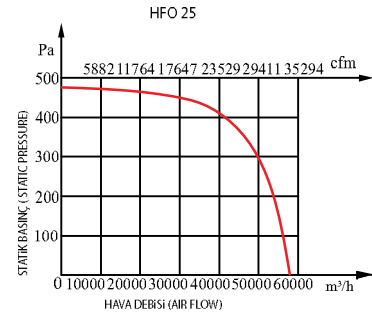
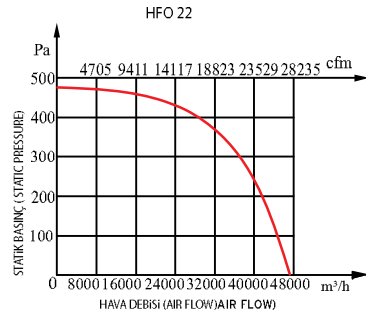
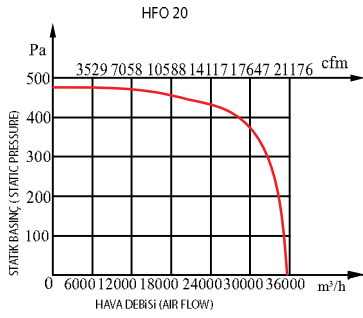
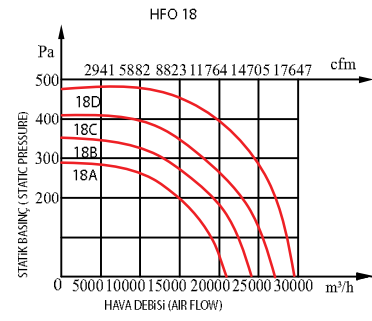
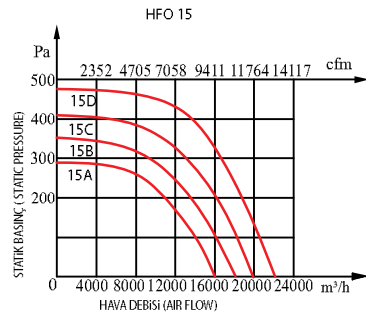
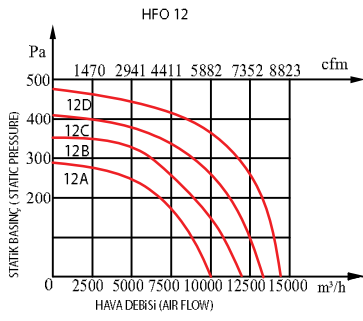
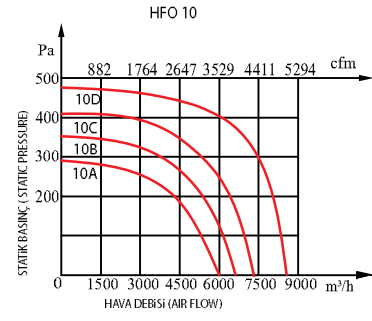
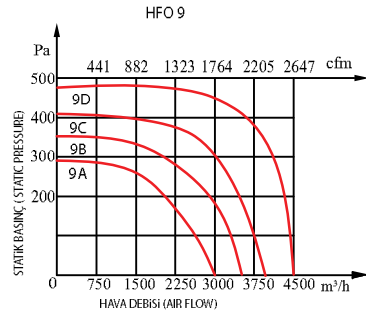
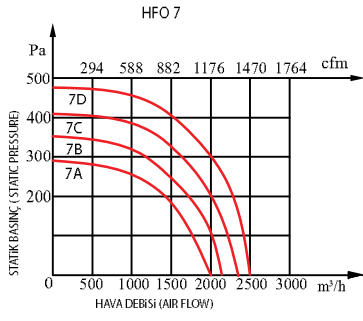

TEKNİK ÇİZİM VE ÖLÇÜLER / TECHNICAL DRAWINGS AND DIMENSIONS

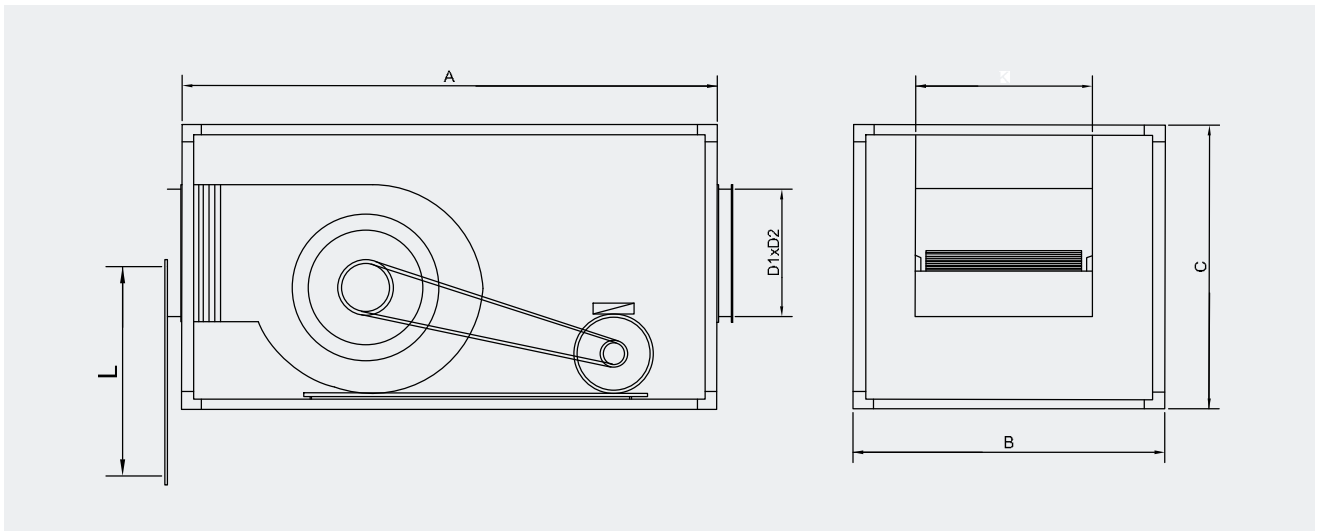

| Tip /Type | A | B | C | D1 | D2 | K | L |
|----------------------------|------|------|------|------|-----|-----|-----|
| HFO-7-4K-M HFO-7-4K-T | 800 | 600 | 600 | 280 | 280 | 232 | 208 |
| HFO-9-4K-M HFO-9-4K-T | 850 | 650 | 650 | 350 | 350 | 298 | 262 |
| HFO-10-4K-M HFO-10-4K-T | 900 | 750 | 750 | 380 | 380 | 331 | 289 |
| HFO-12-4K-M HFO-12-4K-T | 1000 | 800 | 800 | 450 | 450 | 395 | 341 |
| HFO-15-4K-M HFO-15-4K-T | 1100 | 900 | 900 | 520 | 520 | 471 | 404 |
| HFO-18-4K-M HFO-18-4K-T | 1250 | 1050 | 1050 | 600 | 600 | 557 | 478 |
| HFO-20-4K-T | 1500 | 1400 | 1400 | 1000 | 700 | 638 | 638 |
| HFO-22-4K-T | 1750 | 1700 | 1700 | 1200 | 800 | 715 | 715 |
| HFO-25-4K-T | 1850 | 1800 | 1800 | 1400 | 900 | 801 | 801 |

*Ölçüler mm cinsindedir. / Dimensions are in (mm)

AKSESUARLAR / ACCESSORIES

MHA



DHA



YKS



DKS

* Bu ürünler ile ilgili detaylı bilgiyi Aksesuarlar bölümünde bulabilirsiniz.
You can see the details of these products in Accessories section.

